

## Unique Features:

### Zig-Zag Fixation:

The Zig-Zag portion of the pacing wire is embedded into the desired area of the myocardium (epicardially). When extracted, the Zig-Zag portion straightens out to allow easy removal of the wire with minimal traumatic side effects and bleeding.



### Tines Fixation:

The tines are strong enough to fixate the wire in the desired area of the myocardium (epicardially), yet soft enough that when pulled, release the wire out of the myocardium with minimal traumatic side effects and bleeding.



### V-hook Fixation:

The V-shaped heartwire is fixed to the surface of the heart by ligatures at the V-hook. Removal of the lead is achieved with gentle pulling. When the V-hook straightens out, it releases out of the loop of the ligature with minimal traumatic side effects and bleeding.



### Protected Connector Pins:

The chest needle of all Oscor pacing heartwires is exceptionally fine and small in diameter to ease chest insertion. The chest needle comes in either a straight or curved version. When cut off, the standard 2 mm connector pin assembly can be quickly and easily attached to the wire. The connector pins can then be directly connected to an external pacemaker or an extension cable. When not in use, the connector pins can be capped for protection.

**NO NEEDLE BREAKING REQUIRED.**

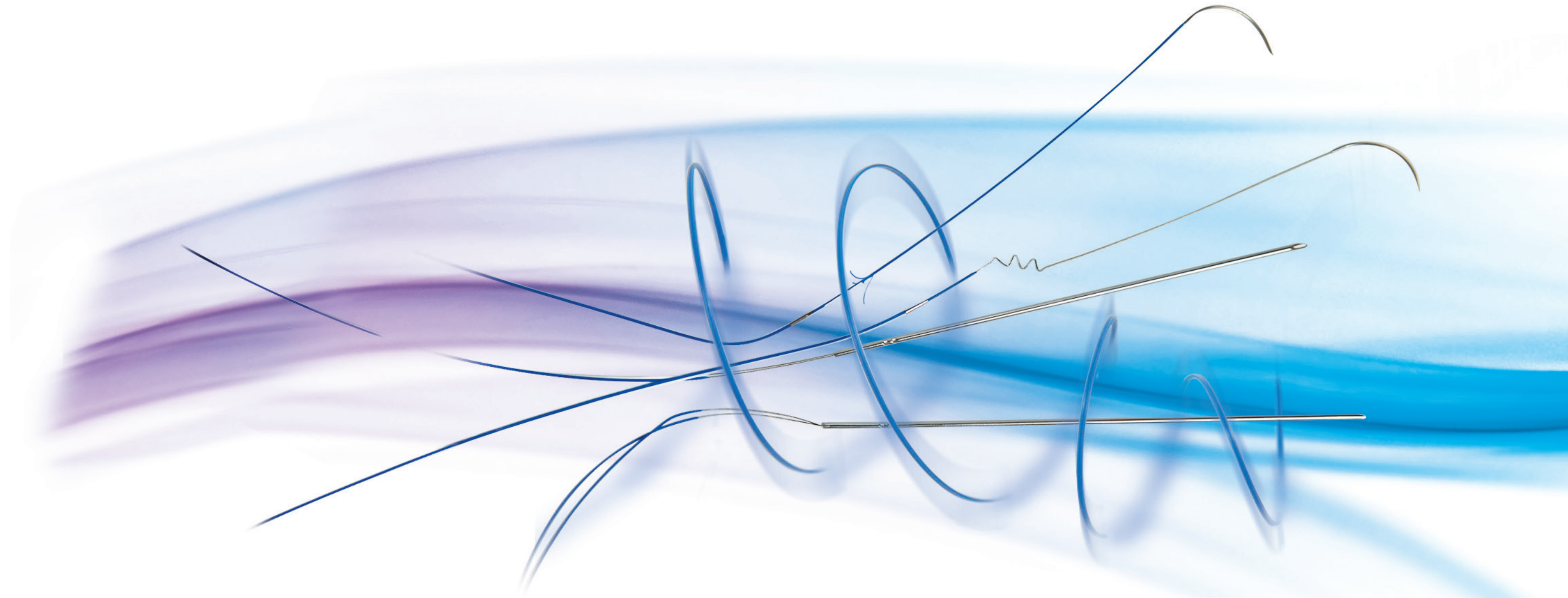
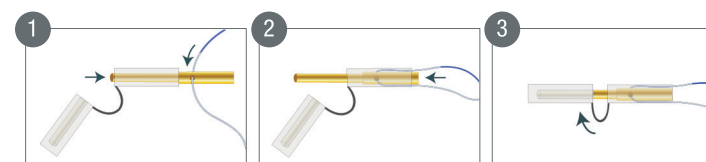

# TME™

Temporary  
Myocardial  
Heartwires





The Ocor line of **Temporary Myocardial Pacing Heartwires**, the TME™ series, includes models that offer reliable unipolar, bipolar and quadripolar pacing and sensing of the atrium and ventricle. All TME™ heartwires are smallest in wire diameter and needle size for minimal trauma. Several models are available, ideally suited for small and large hearts, while giving excellent stimulation and sensing characteristics.

**OSCOR RELATED PRODUCTS**

- PACE 101H and PACE 203H Single and Dual Chamber Pacemakers
- TB™ temporary pacing leads, HELIOS™ temporary pacing lead with balloon
- ATAR™ temporary extension cables are available in several lengths and pin configurations

Model No. Straight Thoracic Needle	Model No. Curved Thoracic Needle	Polarity	Fixation	Wire Length	Electrode Spacing	Insulation	Qty Per Box
<b>UNIPOLAR</b>							
TME 60 S (Straight)	TME 60 C (Curved)	Unipolar	Zig-Zag	60 cm	Variable	Blue	25
TME 60 TS (Straight)	TME 60 TC (Curved)	Unipolar	Tines	60 cm	Variable	Blue	25
TME 61 S (Straight)	TME 61 C (Curved)	Unipolar	Zig-Zag	60 cm	Variable	White	25
TME 61 TS (Straight)	TME 61 TC (Curved)	Unipolar	Tines	60 cm	Variable	White	25
<b>BIPOLAR</b>							
TME 64 S (Straight)	TME 64 C (Curved)	Bipolar	Zig-Zag	60 cm	10 mm/1 cm	Blue/Blue	25
TME 64 S-3 (Straight)	TME 64 C-3 (Curved)	Bipolar	Zig-Zag	60 cm	30 mm/3 cm	Blue/Blue	25
TME 64 TS (Straight)	TME 64 TC (Curved)	Bipolar	Tines	60 cm	2.5 mm/0.25 cm	Blue/Blue	25
TME 65 S (Straight)	TME 65 C (Curved)	Bipolar	Zig-Zag	60 cm	10 mm/1 cm	White/White	25
TME 65 TS (Straight)	TME 65 TC (Curved)	Bipolar	Tines	60 cm	2.5 mm/0.25 cm	White/White	25
TME 66 S (Straight)	TME 66 C (Curved)	Bipolar	Zig-Zag	60 cm	10 mm/1 cm	Blue/White	25
TME 66 S-3 (Straight)	TME 66 C-3 (Curved)	Bipolar	Zig-Zag	60 cm	30 mm/3 cm	Blue/White	25
TME 66 TS (Straight)	TME 66 TC (Curved)	Bipolar	Tines	60 cm	2.5 mm/0.25 cm	Blue/White	25
TME 224 S (Straight)	TME 224 C (Curved)	Bipolar	Zig-Zag	220 cm	10 mm/1 cm	Blue/Blue	10
TME 224 TS (Straight)	TME 224 TC (Curved)	Bipolar	Tines	220 cm	2.5 mm/0.25 cm	Blue/White	10
TME 225 S (Straight)	TME 225 C (Curved)	Bipolar	Zig-Zag	220 cm	10 mm/1 cm	White/White	10
TME 225 TS (Straight)	TME 225 TC (Curved)	Bipolar	Tines	220 cm	2.5 mm/0.25 cm	White/White	10
TME 226 S (Straight)	TME 226 C (Curved)	Bipolar	Zig-Zag	220 cm	10 mm/1 cm	Blue/White	10
<b>BIPOLAR PEDIATRIC</b>							
TME 62 TS (Straight)	TME 62 TC (Curved)	Bipolar	Tines	60 cm	2.5 mm/0.25 cm	Blue/Blue	25
TME 63 TS (Straight)	TME 63 TC (Curved)	Bipolar Bifurcated	Tines	60 cm	Variable	Blue/Blue	25
TME 222 TS (Straight)	TME 222 TC (Curved)	Bipolar	Tines	220 cm	2.5 mm/0.25 cm	Blue/Blue	10
TME 223 TS (Straight)	TME 223 TC (Curved)	Bipolar Bifurcated	Tines	220 cm	Variable	Blue/Blue	10
<b>QUADRIPOlar</b>							
TME 68 S (Straight)	TME 68 C (Curved)	Quadripolar	Zig-Zag	60 cm	10 mm/1 cm	2 Blue/2 White	10
TME 227 TS (Straight)	TME 227 TC (Curved)	Quadripolar	Tines	220 cm	Variable	2 Blue/2 White	10
TME 228 S (Straight)	TME 228 C (Curved)	Quadripolar	Zig-Zag	220 cm	10 mm/1 cm	2 Blue/2 White	10
TME 228 TS (Straight)	TME 228 TC (Curved)	Quadripolar	Tines	220 cm	2.5 mm/0.25 cm	2 Blue/2 White	10
TME 228 TS (Straight)	TME 228 TC (Curved)	Quadripolar	Tines	220 cm	10 mm/1 cm	2 Blue/2 White	10
<b>QUADRIPOlar PEDIATRIC</b>							
TME 220 VS (Straight)	TME 220 VC (Curved)	Quadripolar	V-hook	220 cm	Variable	2 Blue/2 White	10

Heartwires supplied sterile. For single use only. Standard lengths are noted above. Custom configurations available upon request. Sterile kit contains: one heartwire and pin(s) per pouch.

**Unipolar (TME 60/61)**

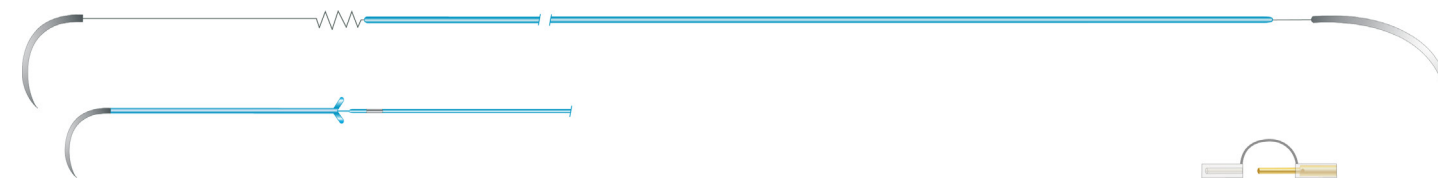

**Bipolar (TME 64/65/66–TME 224/225/226)**

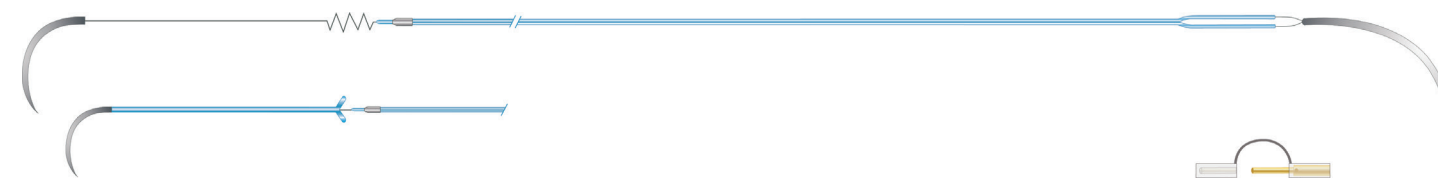

**Bipolar Pediatric (TME 62/63–TME 222/223)**

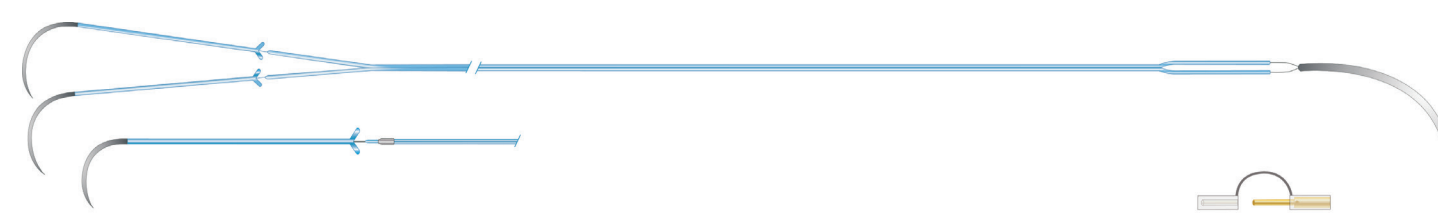

**Quadripolar (TME 227–4x Unipolar)**

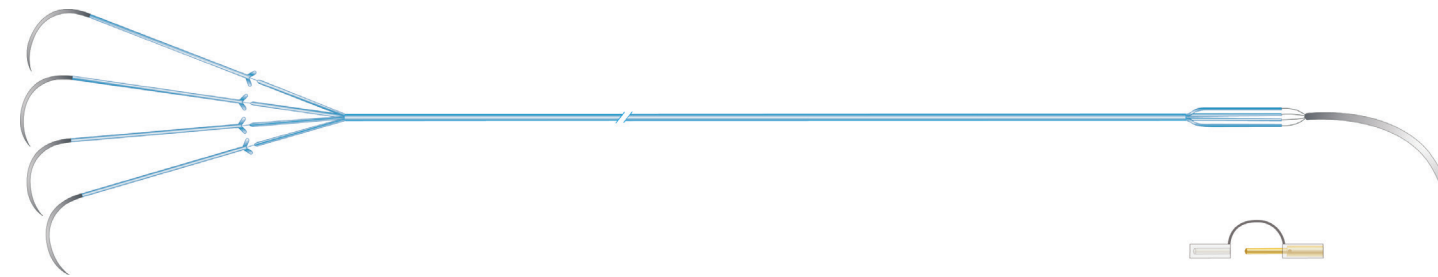

**Quadripolar (TME 68/228–2x Bipolar)**

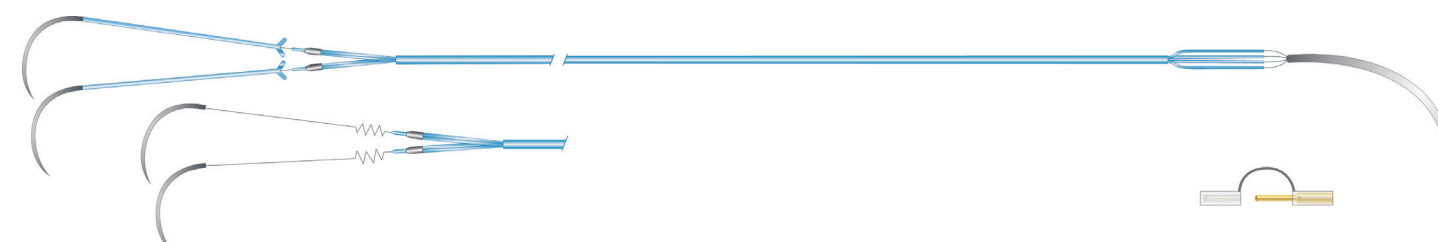

**Quadripolar Pediatric (TME 220–4x Unipolar)**

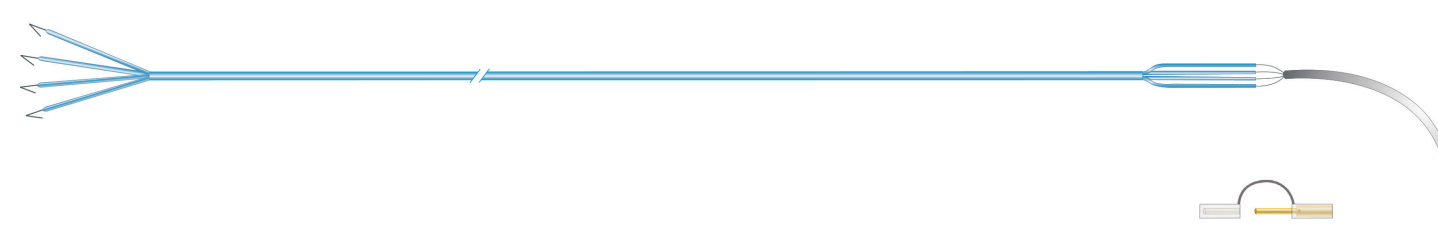

**Unipolar Series:**

- Curved atraumatic myocardial distal needle
- Available in either zig-zag or tines fixation
- Allows for variable electrode spacing
- Available with curved or straight chest needle
- Supplied with a 2 mm pin

**Bipolar Series:**

- Smallest bipolar profile pacing heartwires with atraumatic distal needles
- Optimal electrode spacing for excellent stimulation and sensing
- Only one lead per cardiac chamber
- Available with curved or straight chest needle
- Supplied with two 2 mm pins

**Bipolar Pediatric Series:**

- Lowest profile conductor wire and smallest atraumatic heart needle
- Bipolar configuration with small profile conductors and short electrode spacing
- Available in single wire or bifurcated wire design
- Only one lead per cardiac chamber
- Supplied with two 2 mm pins

**Quadripolar Series:**

- Consistent pacing and sensing in the atrium and ventricle by combining two bipolar or four unipolar wires in one lead design
- Color coded for easy set up and connection
- Allows A-V sequential pacing with only one lead body
- 220 cm length allows easy and direct connection to external pacemaker with no need for an extension cable
- Supplied with four 2 mm pins

**Quadripolar Pediatric Series:**

- Atraumatic fixation through attachment with surgical sutures
- Practically suitable for small hearts and atrial pacing
- Allows A-V sequential pacing with only one lead body
- 220 cm length allows easy and direct connection to external pacemaker with no need for an extension cable
- Supplied with four 2 mm pins